

# Roanoke County Schools

## Three Year AHERA Reinspection

Glenvar Middle School  
Facility 034

Reinspection Date:  
February 12, 2008

***Baratta & Associates, Inc***  
PO Box 293  
Vinton, Virginia 24179  
540-890-4875

Michael Baratta, PE  
Virginia Asbestos Inspector License: 3303-000065  
Virginia Asbestos Management Planner License: 3304-000208

**Baratta & Associates, Inc.**

Virginia Department of Education  
Energy and Facilities Service

LEA Roanoke County Schools  
School 034 Glenvar Middle School  
Building Main

**SCHOOL BUILDINGS**

Building Name	Location	Check here for the presence of:				No ACBM
		ACBM		Suspect ACBM		
		Friable	Non- friable	Friable	Non- friable	
034 Glenvar Middle School	455 Malus Drive Salem, VA 24153					X

Inspector:

Name: Michael Baratta

Signature 

Date

2/25/09

Accreditation Number: 3303 000065 Agency: Virginia DPOR

Virginia Department of Education  
Energy and Facilities Services

LEA Roanoke County Schools  
School: 034 Glenvar Middle School  
Building: Main

**DETERMINATION OF EACH  
SAMPLE AREA**

Glenvar Middle School was built in 1996 and 2001. We assumed that no ACMs were used in its construction. Fiberglass TSI was observed through-out the building. We obtained several samples of the lay-in ceiling panels (LICs) as they were the most friable potentially suspect materials observed.

Homogeneous Area	Material	Sample Number	Location
01	LIC 2' x 2', random pattern	B1	132, center of room
		B2	225, center of room
02	LIC 2' x 2', textured with revealed edge	B3	Mechanical Room 232, stored material
		B4	Hall at 120

Name: Michael Baratta Signature  Date 2/25/09  
Accreditation Number: 3303 000065 Agency: Virginia DPOR



AHERA Three Year Inspection  
Glenvar Middle School  
Roanoke County Schools  
Sample date:

Building 034  
Sample Locations  
L001  
February 12, 2008

HA-01 LIC 2'x2', random pattern  
Samples B1, B2

HA-02 LIC 2'x2', textured with revealed edge  
Samples B3, B4

Positive Samples in **Bold**

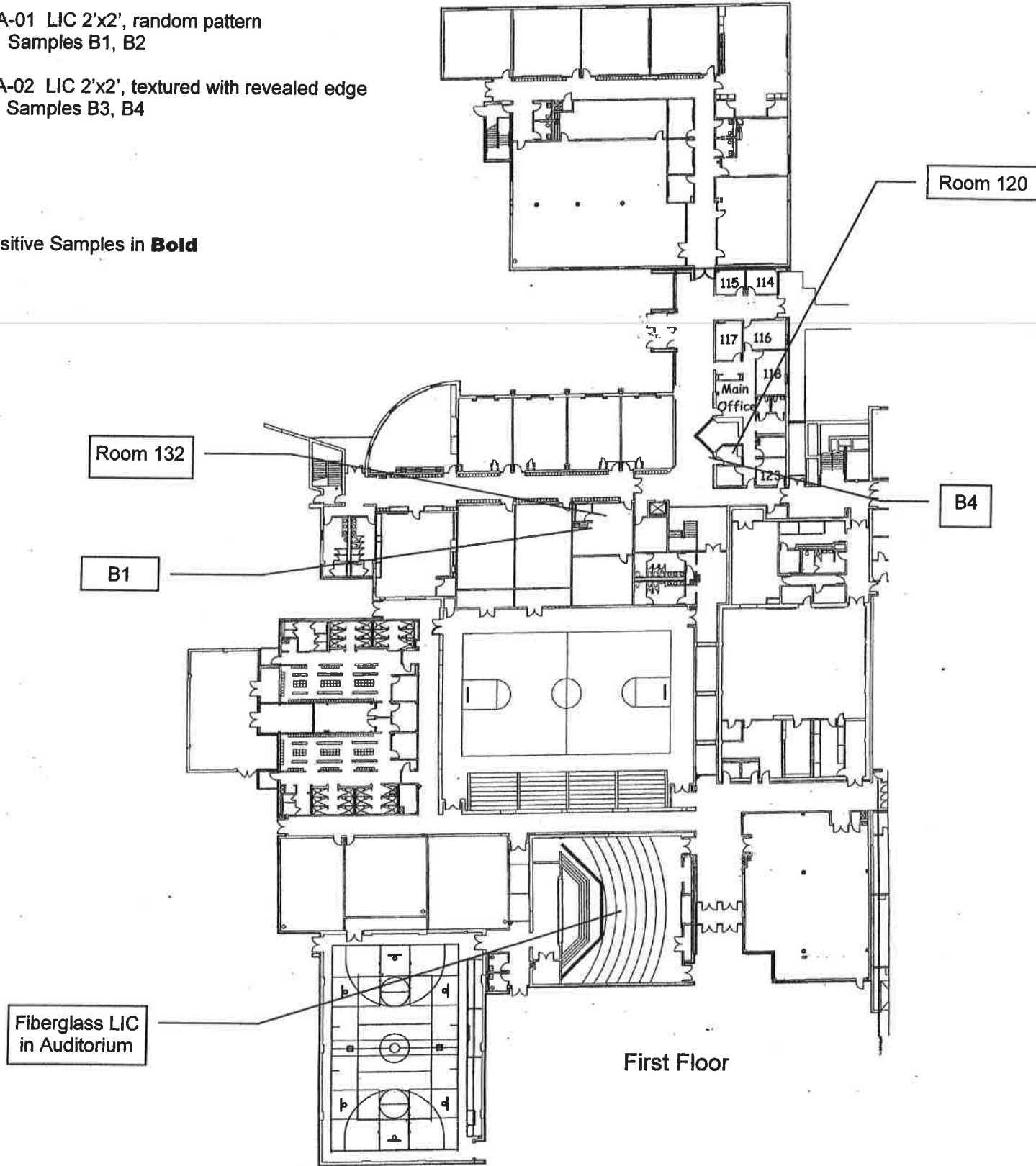



AHERA Three Year Inspection  
Glenvar Middle School  
Roanoke County Schools  
Sample date:

Building 034  
Sample Locations  
L001  
February 12, 2008

HA-01 LIC 2'x2' random pattern  
Samples B1, B2

HA-02 LIC 2'x2', textured with revealed  
edge  
Samples B3, B4

Positive Samples in **Bold**

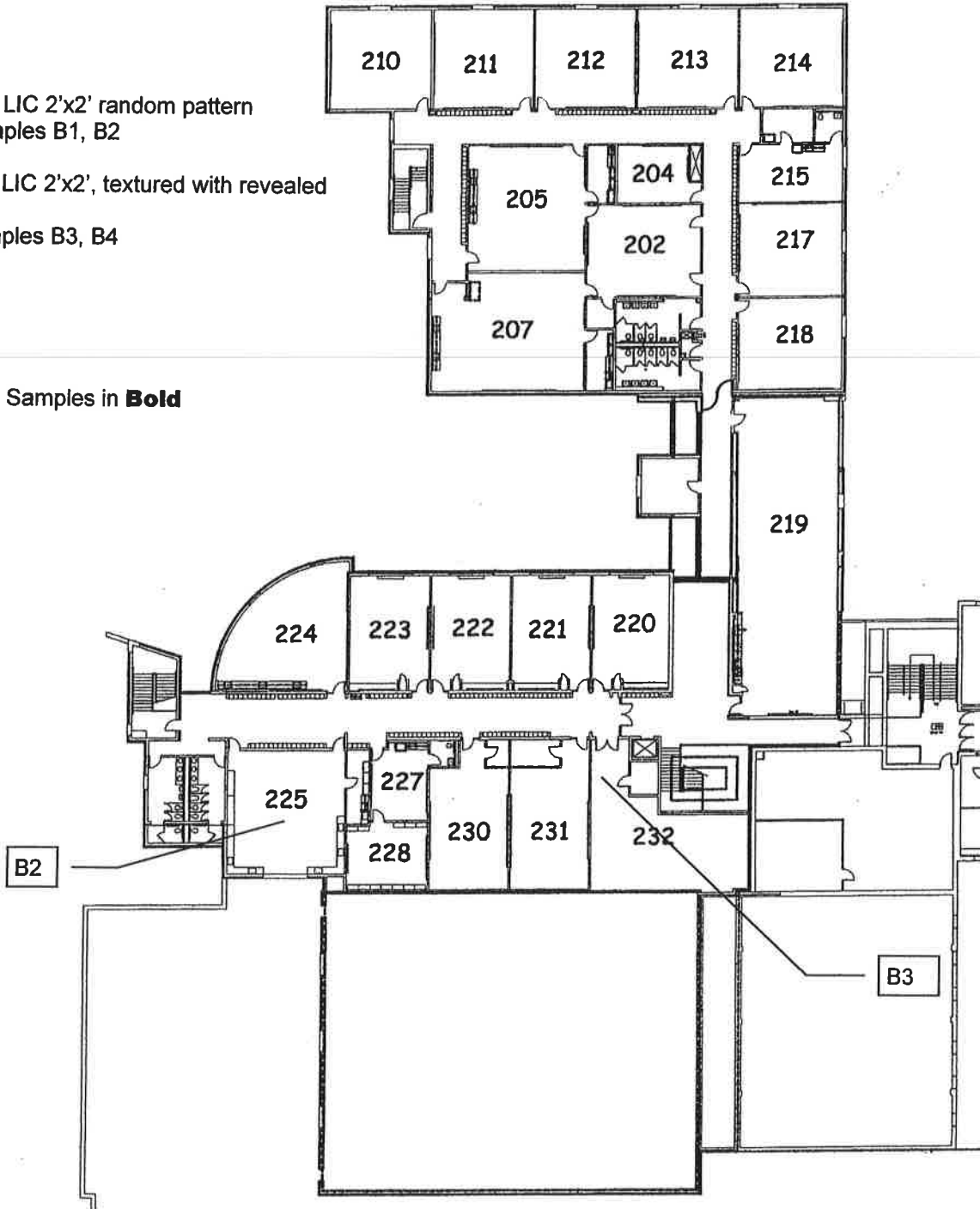

Second Floor

Virginia Department of Education  
Energy and Facilities Services

Document E.1

LEA Roanoke County Schools  
School: 034 Glenvar Middle School  
Building: Main  
Sample Date: February 12, 2008  
Analysis Date: February 13, 2008  
Analysis Method: PLM EPA 6000/M4-82-020

**BULK SAMPLE ANALYSIS**

Homogeneous Area	Sample Number	Material	Asbestos Content
01	B1	LIC 2' x 2', random pattern	NAD
	B2		NAD
02	B3	LIC 2' x 2', textured with revealed edge	NAD
	B4		NAD

NAD – no asbestos detected

See attached AmeriSci PLM Bulk Asbestos Report Number 108021378

Name: Michael Baratta Signature  Date 2/25/08  
Accreditation Number: 3303 000065 Agency: Virginia DPOR



**AmeriSci Richmond**  
13635 GENITO ROAD  
MIDLOTHIAN, VIRGINIA 23112  
TEL: (804) 763-1200 • FAX: (804) 763-1800

## PLM Bulk Asbestos Report

Baratta & Associates, Inc.  
Attn: Michael Baratta  
1150 Shady Run Road

Date Received 02/13/08      AmeriSci Job # 108021378  
Date Examined 02/13/08      P.O. #  
Page 1 of 2  
RE: L001; Glenvan Middle School

Vinton, VA 24179

Client No. / HGA	Lab No.	Asbestos Present	Total % Asbestos
B1 Location: Lay-In-Ceiling	108021378-01	No	NAD (by CVES) by William M. Dunstan on 02/13/08
<b>Analyst Description:</b> Gray, Heterogeneous, Fibrous, Bulk Material <b>Asbestos Types:</b> <b>Other Material:</b> Cellulose 30 %, Fibrous glass 40 %, Non-fibrous 30 %			
B2 Location: Lay-In-Ceiling	108021378-02	No	NAD (by CVES) by William M. Dunstan on 02/13/08
<b>Analyst Description:</b> Gray, Heterogeneous, Fibrous, Bulk Material <b>Asbestos Types:</b> <b>Other Material:</b> Cellulose 30 %, Fibrous glass 40 %, Non-fibrous 30 %			
B3 Location: Lay-In-Ceiling	108021378-03	No	NAD (by CVES) by William M. Dunstan on 02/13/08
<b>Analyst Description:</b> Gray, Heterogeneous, Fibrous, Bulk Material <b>Asbestos Types:</b> <b>Other Material:</b> Cellulose 30 %, Fibrous glass 40 %, Non-fibrous 30 %			
B4 Location: Lay-In-Ceiling	108021378-04	No	NAD (by CVES) by William M. Dunstan on 02/13/08
<b>Analyst Description:</b> Gray, Heterogeneous, Fibrous, Bulk Material <b>Asbestos Types:</b> <b>Other Material:</b> Cellulose 25 %, Fibrous glass 50 %, Non-fibrous 25 %			

Client Name: Baratta & Associates, Inc.

# PLM Bulk Asbestos Report

L001; Glenvan Middle School

**Reporting Notes:**

Analyzed by: William M. Dunstan William Dunstan Date 2/12/08  
\*NAD = no asbestos detected, Detection Limit <1%, Reporting Limits: CVES = 1%, 400 Pt Ct = 0.25%, 1000 Pt Ct = 0.1%; "Present" or NVA = "No Visible Asbestos" are observations made during a qualitative analysis; NA = not analyzed; NA/PS = not analyzed / positive stop; PLM Bulk Asbestos Analysis by EPA 600/M4-82-020 per 40 CFR 763 (NVLAP Lab Code 101904-0) and ELAP PLM Analysis Protocol 198.1 for New York friable samples (198.6 for NOB samples)(NYSDOH ELAP Lab # 10984); CA ELAP Lab # 2508; Note: PLM is not consistently reliable in detecting asbestos in floor coverings and similar NOB materials. NAD or Trace results by PLM are inconclusive, TEM is currently the only method that can be used to determine if this material can be considered or treated as non-asbestos-containing in New York State (also see EPA Advisory for floor tile, FR 59, 146, 38970, 8/1/94). NIST Accreditation requirements mandate that this report must not be reproduced except in full without the approval of the laboratory. This PLM report relates ONLY to the items tested:  
Reviewed By: .....



**Baratta & Associates, Inc.**  
 P.O. Box 293  
 Vinton, Virginia

LEA Roanoke County Schools  
 School 034 Glenvar Middle School  
 Building \_\_\_\_\_

**REASSESSMENT OF MATERIALS**

Past or Initial Assessment: Hall-Kimbrell April 1989

Homogeneous Area	Description	Past Assessment Category #	Reassessment Category #
01	LIC 2' x 2', random pattern	Not evaluated	Non-ACM
02	LIC 2' x 2', textured with revealed edge	Not evaluated	Non-ACM

AHERA - Physical Assessment Categories - 763.88(a)(2)(b)

- 1 Damaged or significantly damaged TSI-ACBM
- 2 Damaged friable surfacing ACBM
- 3 Significantly damaged friable surfacing ACBM
- 4 Damaged or significantly damaged friable miscellaneous ACBM
- 5 ACBM with potential for damage
- 6 ACBM with potential for significant damage
- 7 Any remaining friable ACBM or friable suspect ACBM

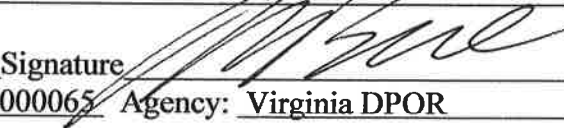
Inspector: \_\_\_\_\_  
 Name: Michael Baratta Signature  Date 2/25/04  
 Accreditation Number: 3303 000065 Agency: Virginia DPOR

Virginia Department of Education  
Energy and Facilities Service

LEA Roanoke County Schools  
School 034 Glenvar Middle School  
Building: \_\_\_\_\_

**RESPONSE ACTIONS  
RECOMMENDED**

Total cost to remove \$0.00

Each Location	Recommended Response Actions	Scheduled To Begin	Scheduled To Be Completed	Est. Cost To Remove
none				\$0.00

Management Planner:  
 Name: Michael Baratta Signature  Date 2/25/13  
 Accreditation Number: 3304 000208 Agency: Virginia DPOR

## **ASBESTOS MANAGEMENT, OPERATIONS AND MAINTENANCE PLAN**

Glenvar Middle School  
February 23, 2008

This Asbestos Management Operations and Maintenance Plan is based on the three year AHERA Reinspection performed by Baratta & Associates, Inc on February 12, 2008. It covers procedures to be followed in dealing with the Asbestos-Containing Materials (ACMs) found in the Glenvar Middle School.

### **SUMMARY**

Glenvar Middle School was built in 1996 and 2001. We assumed no ACMs were used in its construction.

Non-suspect fiberglass thermal system insulation (TSI) was noted through-out the facility.

Samples from the more friable lay-in ceiling tiles (LICs) tested no asbestos detected.

### **RECOMMENDED ASBESTOS RELATED PROCEDURES**

No asbestos related procedures are present at this time.

Should additional suspect materials be damaged or if they are questioned, we recommend they be sampled and tested for asbestos mineral content. The results of these tests will dictate what, if any, response actions are applicable.