

Roanoke County Schools

Three Year AHERA Reinspection

Green Valley Elementary School
Facility 019

Reinspection Dates:

May 6, 2008

June 24, 2008

Baratta & Associates, Inc

PO Box 293

Vinton, Virginia 24179

540-890-4875

Michael Baratta, PE

Virginia Asbestos Inspector License: 3303-000065

Virginia Asbestos Management Planner License: 3304-000208

Baratta & Associates, Inc.

Virginia Department of Education
Energy and Facilities Service

LEA Roanoke County Schools
School 019 Green Valley Elementary School
Building Main

SCHOOL BUILDINGS

Building Name	Location	Check here for the presence of:				No ACBM
		ACBM		Suspect ACBM		
		Friable	Non- friable	Friable	Non- friable	
Green Valley Elementary School	3838 Overdale Road	X	X			

Inspector:

Name: Michael Baratta

Signature

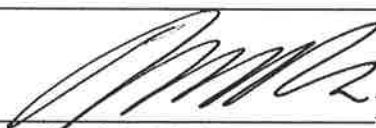

Date

7/3/06

Accreditation Number: 3303 000065 Agency: Virginia DPOR

Virginia Department of Education
Energy and Facilities Services

LEA Roanoke County Schools
School: 019 Green Valley Elementary School
Building: Main

DETERMINATION OF EACH SAMPLE AREA

The gypsumboard systems (HA-01) and the roof drain fitting TSI were not evaluated by H-K. Three (3) samples of these products were obtained. We divided the floor tile (HA-07) into its tile (7A) and mastic (7B) components and took two (2) samples each. We could not tell if the old breeching TSI (HA-9) had been removed and replaced or if it was left in place. Three (3) samples of the existing breeching TSI were, therefore, obtained.

An inconsistency was noted in the HK samples for LIC (HA-06). Sample 042 was positive but HA-06 was designated as a non-ACM the "List of Materials by Category". We took five (5) samples of HA-06 on May 6th. One (1) of the samples (06-1) tested positive and the others negative. On June 26th we returned to the school to take a further look at HA-06. Numerous salient LIC panels were observed. We then subdivided HA-06 in to Type I (HA-06A) and Type II (HA-06B) and took additional samples in an attempt to isolate the asbestos containing panels.

Homogeneous Area	Material	Sample Number	Location
01	Gypsumboard system	01-1	N wall of hall at 6
		01-2	S wall of hall at 10
		01-3	S hall, SW corner
		01-4	N hall as SW corner of 4
05	Roof drain fitting TSI	05A	Room E of boiler Room
		05B	Room E of boiler Room
		05C	Room E of boiler Room
06	LIC 2' x 2', parallel long holes	06-1	Music Room SE corner
		06-2	Hall at 19
		06-3	Upper N hall, NE corner
		06-4	Upper N Hall at 7
		06-5	Hall at 1
06A	LIC 2' x 2' Type I, parallel long hole, grey back with "install arrow"	06A-1	Music Room SE corner
		06A-2	Music Room SW corner
		06A-3	Hall at Gym Office
06B	LIC 2' x 2', Type II parallel long holes, tan back	06B-1	Music Room, center of room
		06B-2	Hall at Gym Office
		06B-3	Lower Hall at 19
		06B-4	Upper N hall, NE corner
		06B-5	Upper N hall at 7
		06B-6	Upper N hall at 3

Homogeneous Area	Material	Sample Number	Location
07A	Floor tile 9"x9", white with tan streaks	07A-1	Music Room at hall door
		07A-2	Gym Office
07B	Black mastic for HA-07A	07B-1	Music Room at hall door
		07B-2	Gym Office
09	Breeching TSI	09A	Boiler Room
		09B	Boiler Room
		09C	Boiler Room

Name: Michael Baratta Signature



Date

7/3/09

Accreditation Number: 3303 000065 Agency: Virginia DPOR

- HA-06 LIC 2'x2'; parallel long holes
 Samples 06-1; 06-2
- HA-06A LIC 2'x2'; Type 1, parallel long hole, grey back with "install arrow"
 Samples 06A-1; 06A-2; 06A-3;
- HA-06B LIC 2'x2'; Type II parallel long, tan back
 Samples 06B-1, 06B-2, 06B-3
- HA-07A Floor tile 9"x9", white with tan streaks
 Samples 07A-1; 07A-2
- HA-07B Black mastic for HA-07A
 Samples 07B-1; 07B-2

Positive Samples in **Bold**

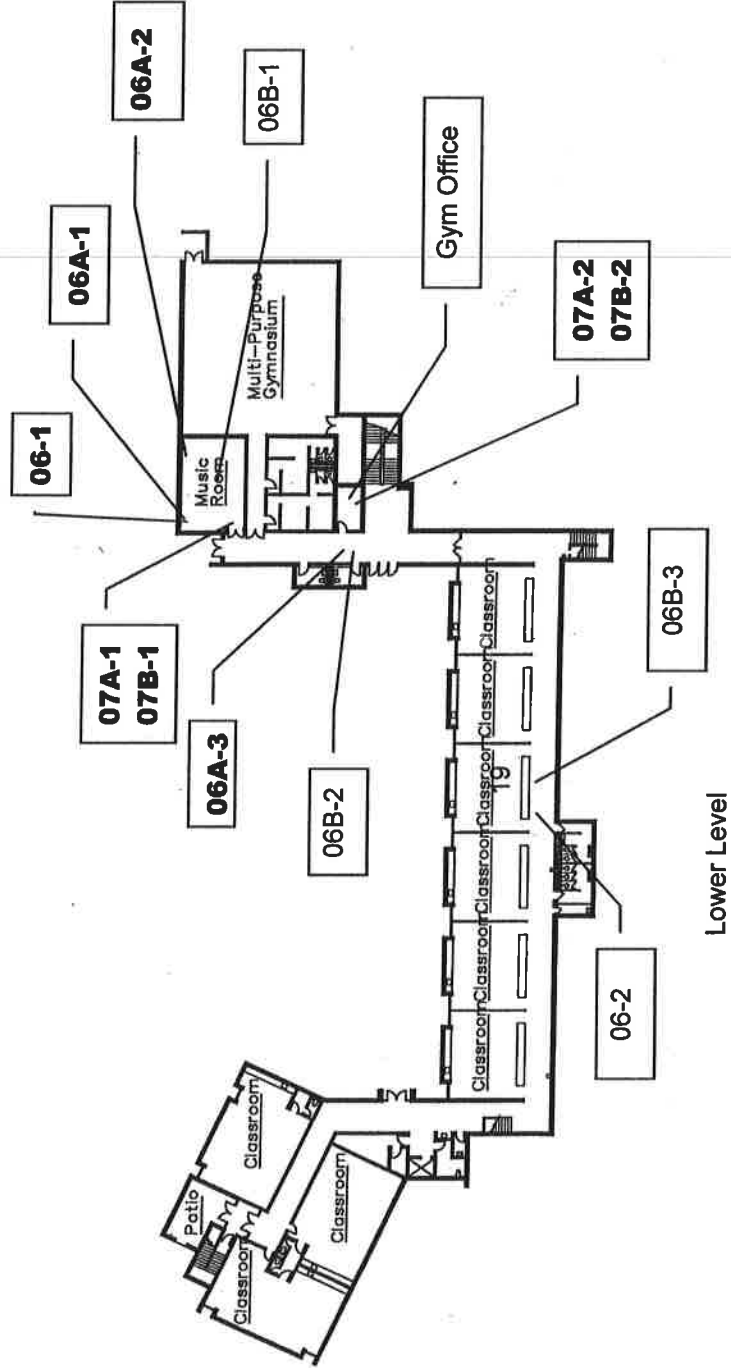

HA-01 Gypsum board System
Samples 01-1; 01-2; -01-3; 01-4

HA-05 Roof drain fitting TSI
Samples 05-A; 05-B; 05-C

HA-06 LIC 2'x2', long holes parallel to short side
Samples 06-3, 06-4; 06-5

HA-06B LIC 2'x2', Type II long holes parallel to short side, tan back
Samples 06B-4; 06B-5; 06B-6

HA-09 Breaching TSI
Samples 09A; 09B; 09C

AHERA Three Year Inspection
Green Valley Elementary School
Roanoke County Schools
Sample dates:

Building 019
Sample Locations
L001
May 6, 2008
June 24, 2008

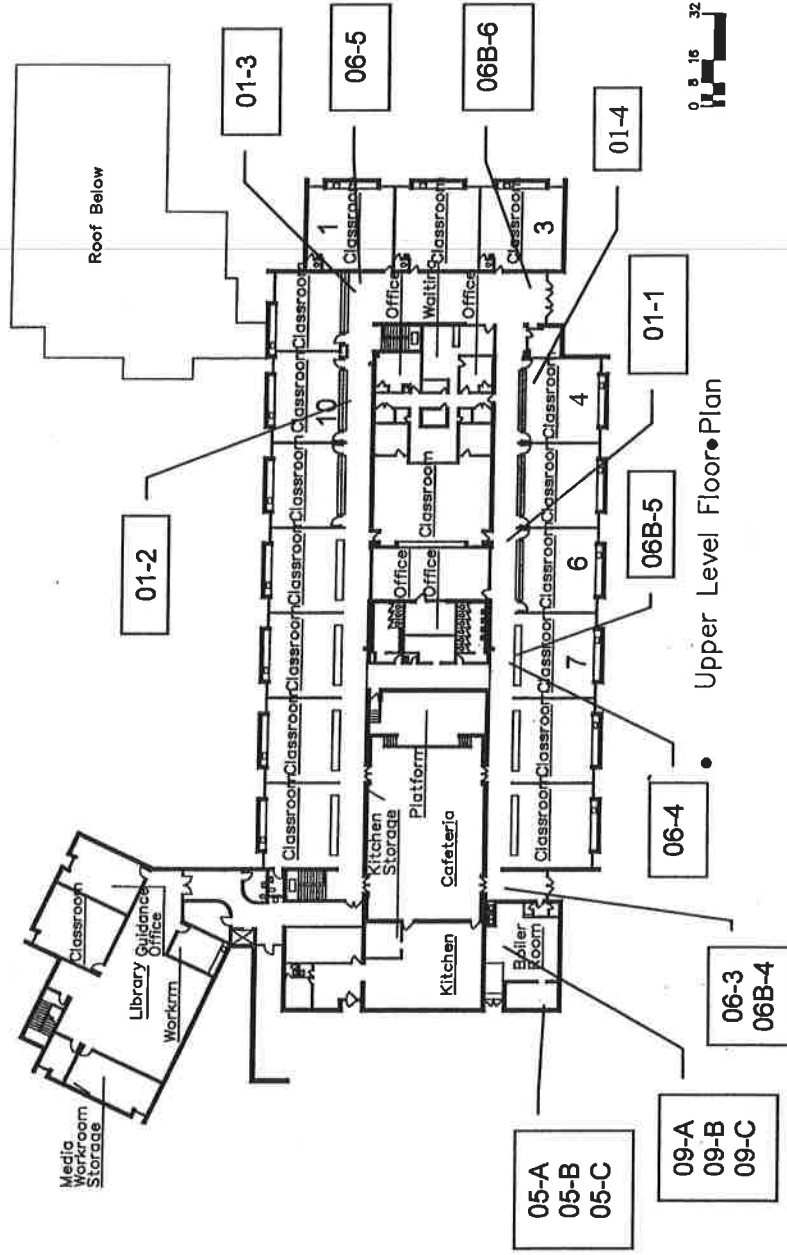

Virginia Department of Education
Energy and Facilities Services

LEA Roanoke County Schools
School: 019 Green Valley Elementary School
Building: Main
Sample Date: May 6, 2008, June 24, 2008
Analysis Date: May 14, 2008, June 26, 2008
Analysis Method: PLM EPA 6000/M4-82-020

BULK SAMPLE ANALYSIS

Homogeneous Area	Sample Number	Material	Asbestos Content
01	01-1	Gypsumboard system	NAD
	01-2		NAD
	01-3		NAD
	01-4		NAD
05	05A	Roof drain TSI	NAD
	05B		NAD
	05C		NAD
06	06-1	LIC 2' x2', parallel long holes	2 % chrysotile
	06-2		NAD
	06-3		NAD
	06-4		NAD
	06-5		NAD
06A	06A-1	LIC 2' x 2' Type I, parallel long hole, grey back with "install arrow"	3 % chrysotile
	06A-2		3 % chrysotile
	06A-3		3 % chrysotile
06B	06B-1	LIC 2' x 2', Type II parallel long, tan back	NAD
	06B-2		NAD
	06B-3		NAD
	06B-4		NAD
	06B-5		NAD
	06B-6		NAD
07A	07A-1	Floor tile 9"x9", white with tan streaks	3 % chrysotile
	07A-2		3 % chrysotile
07B	07B-1	Black mastic for HA-07A	7 % chrysotile
	07B-2		7 % chrysotile
09	09A	Breeching TSI	NAD
	09B		NAD
	09C		NAD

NAD – no asbestos detected

See attached AmeriSci PLM Bulk Asbestos Report Numbers 108051235 and 018061853

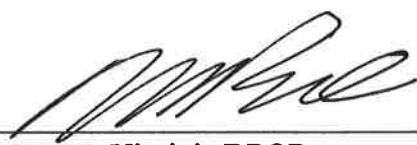
Name: Michael Baratta Signature  Date 7-3-08
Accreditation Number: 3303 000065 Agency: Virginia DPOR



AmeriSci Richmond
13635 GENITO ROAD
MIDLOTHIAN, VIRGINIA 23112
TEL: (804) 763-1200 • FAX: (804) 763-1800

PLM Bulk Asbestos Report

Baratta & Associates, Inc.
Attn: Michael Baratta
1150 Shady Run Road

Vinton, VA 24179

Date Received 05/09/08 AmeriSci Job # 108051235
Date Examined 05/13/08 P.O. #
Page 1 of 4
RE: L001; AHERA; Green Valley ELS

Client No. / HGA	Lab No.	Asbestos Present	Total % Asbestos
01-1 Location: Gypsum Board System	108051235-01	No	NAD (by CVES) by Gordon T. Saleeby on 05/13/08
Analyst Description: Off White, Heterogeneous, Non-Fibrous, Bulk Material Asbestos Types: Other Material: Cellulose 2 %, Non-fibrous 98 %			
01-2 Location: Gypsum Board System	108051235-02	No	NAD (by CVES) by Gordon T. Saleeby on 05/13/08
Analyst Description: Off-White/Brown, Heterogeneous, Non-Fibrous, Bulk Material Asbestos Types: Other Material: Cellulose 2 %, Non-fibrous 98 %			
01-3 Location: Gypsum Board System	108051235-03	No	NAD (by CVES) by Gordon T. Saleeby on 05/13/08
Analyst Description: Off-White/Brown, Heterogeneous, Non-Fibrous, Bulk Material Asbestos Types: Other Material: Cellulose 2 %, Non-fibrous 98 %			
01-4 Location: Gypsum Board System	108051235-04	No	NAD (by CVES) by Gordon T. Saleeby on 05/13/08
Analyst Description: Off-White/Brown, Heterogeneous, Non-Fibrous, Bulk Material Asbestos Types: Other Material: Cellulose 2 %, Non-fibrous 98 %			
05A Location: Drain Fitting TSI	108051235-05	No	NAD (by CVES) by Gordon T. Saleeby on 05/13/08
Analyst Description: Lt. Gray, Heterogeneous, Non-Fibrous, Bulk Material Asbestos Types: Other Material: Cellulose 5 %, Fibrous glass 40 %, Non-fibrous 55 %			

See Reporting notes on last page

Client Name: Baratta & Associates, Inc.

PLM Bulk Asbestos Report

L001; AHERA; Green Valley ELS

Client No. / HGA	Lab No.	Asbestos Present	Total % Asbestos
05B Location: Drain Fitting TSI	108051235-06	No	NAD (by CVES) by Gordon T. Saleeby on 05/13/08
Analyst Description: Lt. Gray, Heterogeneous, Non-Fibrous, Bulk Material Asbestos Types: Other Material: Cellulose 5 %, Fibrous glass 40 %, Non-fibrous 55 %			
05C Location: Drain Fitting TSI	108051235-07	No	NAD (by CVES) by Gordon T. Saleeby on 05/13/08
Analyst Description: Lt. Gray, Heterogeneous, Non-Fibrous, Bulk Material Asbestos Types: Other Material: Cellulose 5 %, Fibrous glass 40 %, Non-fibrous 55 %			
06-1 Location: Lay In Ceiling	108051235-08	Yes	2 % (by CVES) by Gordon T. Saleeby on 05/14/08
Analyst Description: White/Lt. Gray, Homogeneous, Fibrous, Bulk Material Asbestos Types: Chrysotile 2.0 % Other Material: Fibrous glass 55 %, Non-fibrous 43 %			
06-2 Location: Lay In Ceiling	108051235-09	No	NAD (by CVES) by Gordon T. Saleeby on 05/14/08
Analyst Description: White/Beige, Homogeneous, Fibrous, Bulk Material Asbestos Types: Other Material: Cellulose 35 %, Fibrous glass 35 %, Non-fibrous 30 %			
06-3 Location: Lay In Ceiling	108051235-10	No	NAD (by CVES) by Gordon T. Saleeby on 05/14/08
Analyst Description: White/Beige, Homogeneous, Fibrous, Bulk Material Asbestos Types: Other Material: Cellulose 35 %, Fibrous glass 35 %, Non-fibrous 30 %			
06-4 Location: Lay In Ceiling	108051235-11	No	NAD (by CVES) by Gordon T. Saleeby on 05/14/08
Analyst Description: White/Beige, Homogeneous, Fibrous, Bulk Material Asbestos Types: Other Material: Cellulose 30 %, Fibrous glass 40 %, Non-fibrous 30 %			

See Reporting notes on last page

Client Name: Baratta & Associates, Inc.

PLM Bulk Asbestos Report

L001; AHERA; Green Valley ELS

Client No. / HGA	Lab No.	Asbestos Present	Total % Asbestos
06-5 Location: Lay In Ceiling	108051235-12	No	NAD (by CVES) by Gordon T. Saleeby on 05/14/08
Analyst Description: White/Beige, Homogeneous, Fibrous, Bulk Material			
Asbestos Types:			
Other Material: Cellulose 30 %, Fibrous glass 40 %, Non-fibrous 30 %			
07A-1 Location: Floor Tile	108051235-13	Yes	3 % (by CVES) by Gordon T. Saleeby on 05/14/08
Analyst Description: Lt. Yellow/Green, Homogeneous, Non-Fibrous, Bulk Material			
Asbestos Types: Chrysotile 3.0 %			
Other Material: Non-fibrous 97 %			
07A-2 Location: Floor Tile	108051235-14	Yes	3 % (by CVES) by Gordon T. Saleeby on 05/14/08
Analyst Description: Lt. Yellow/Green, Homogeneous, Non-Fibrous, Bulk Material			
Asbestos Types: Chrysotile 3.0 %			
Other Material: Non-fibrous 97 %			
07B-1 Location: Floor Tile Mastic	108051235-15	Yes	7 % (by CVES) by Gordon T. Saleeby on 05/14/08
Analyst Description: Black, Homogeneous, Non-Fibrous, Bulk Material			
Asbestos Types: Chrysotile 7.0 %			
Other Material: Non-fibrous 93 %			
07B-2 Location: Floor Tile Mastic	108051235-16	Yes	7 % (by CVES) by Gordon T. Saleeby on 05/14/08
Analyst Description: Black, Homogeneous, Non-Fibrous, Bulk Material			
Asbestos Types: Chrysotile 7.0 %			
Other Material: Non-fibrous 93 %			
09A Location: Breaching TSI	108051235-17	No	NAD (by CVES) by Gordon T. Saleeby on 05/14/08
Analyst Description: Lt. Gray, Homogeneous, Fibrous, Bulk Material			
Asbestos Types:			
Other Material: Cellulose 5 %, Fibrous glass 40 %, Non-fibrous 55 %			

See Reporting notes on last page

PLM Bulk Asbestos Report

L001; AHERA; Green Valley ELS

Client No. / HGA	Lab No.	Asbestos Present	Total % Asbestos
09B Location: Breeching TSI	108051235-18	No	NAD (by CVES) by Gordon T. Saleeby on 05/14/08
Analyst Description: Lt. Gray, Homogeneous, Fibrous, Bulk Material Asbestos Types: Other Material: Fibrous glass 40 %, Non-fibrous 60 %			
09C Location: Breeching TSI	108051235-19	No	NAD (by CVES) by Gordon T. Saleeby on 05/14/08
Analyst Description: Lt. Gray, Homogeneous, Fibrous, Bulk Material Asbestos Types: Other Material: Fibrous glass 40 %, Non-fibrous 60 %			

Reporting Notes:

Analyzed by: Gordon T. Saleeby *Gordon T. Saleeby* Date MAY 14, 2008
 *NAD = no asbestos detected, Detection Limit <1%, Reporting Limits: CVES = 1%, 400 Pt Ct = 0.25%, 1000 Pt Ct = 0.1%; "Present" or NVA = "No Visible Asbestos" are observations made during a qualitative analysis; NA = not analyzed; NA/PS = not analyzed / positive stop; PLM Bulk Asbestos Analysis by EPA 600/M4-82-020 per 40 CFR 763 (NVLAP Lab Code 101904-0) and ELAP PLM Analysis Protocol 198.1 for New York friable samples (198.6 for NOB samples)(NYSDOH ELAP Lab # 10984); CA ELAP Lab # 2508; Note: PLM is not consistently reliable in detecting asbestos in floor coverings and similar NOB materials. NAD or Trace results by PLM are inconclusive, TEM is currently the only method that can be used to determine if this material can be considered or treated as non-asbestos-containing in New York State (also see EPA Advisory for floor tile, FR 59, 146, 38970, 8/1/94). NIST Accreditation requirements mandate that this report must not be reproduced except in full without the approval of the laboratory. This PLM report relates ONLY to the items tested.

Reviewed By: _____



AmeriSci Richmond

13635 GENITO ROAD
MIDLOTHIAN, VIRGINIA 23112
TEL: (804) 763-1200 • FAX: (804) 763-1800

PLM Bulk Asbestos Report

Baratta & Associates, Inc.
Attn: Michael Baratta
1150 Shady Run Road

Vinton, VA 24179

Date Received 06/26/08 AmeriSci Job # 108061853
Date Examined 06/27/08 P.O. #
Page 1 of 2
RE: L001; AHERA; Green Valley Els

Client No. / HGA	Lab No.	Asbestos Present	Total % Asbestos
06A-1 Location: Lay-In Ceiling I	108061853-01	Yes	3 % (by CVES) by C. David Mintz on 06/27/08
Analyst Description: Off White, Heterogeneous, Fibrous, Bulk Material Asbestos Types: Chrysotile 3.0 % Other Material: Fibrous glass 60 %, Non-fibrous 37 %			
06A-2 Location: Lay-In Ceiling I	108061853-02	Yes	3 % (by CVES) by C. David Mintz on 06/27/08
Analyst Description: Off White, Heterogeneous, Fibrous, Bulk Material Asbestos Types: Chrysotile 3.0 % Other Material: Fibrous glass 60 %, Non-fibrous 37 %			
06A-3 Location: Lay-In Ceiling I	108061853-03	Yes	3 % (by CVES) by C. David Mintz on 06/27/08
Analyst Description: Off White, Heterogeneous, Fibrous, Bulk Material Asbestos Types: Chrysotile 3.0 % Other Material: Fibrous glass 60 %, Non-fibrous 37 %			
06B-1 Location: Lay-In Ceiling II	108061853-04	No	NAD (by CVES) by C. David Mintz on 06/27/08
Analyst Description: Off White/ Lt Tan, Heterogeneous, Fibrous, Bulk Material Asbestos Types: Other Material: Cellulose 30 %, Fibrous glass 10 %, Non-fibrous 60 %			
06B-2 Location: Lay-In Ceiling II	108061853-05	No	NAD (by CVES) by C. David Mintz on 06/27/08
Analyst Description: Off White / Lt Tan, Heterogeneous, Fibrous, Bulk Material Asbestos Types: Other Material: Cellulose 30 %, Fibrous glass 10 %, Non-fibrous 60 %			

See Reporting notes on last page

Client Name: Baratta & Associates, Inc.

PLM Bulk Asbestos Report

L001; AHERA; Green Valley Els

Client No. / HGA	Lab No.	Asbestos Present	Total % Asbestos
06B-3 Location: Lay-In Ceiling II	108061853-06	No	NAD (by CVES) by C. David Mintz on 06/27/08
Analyst Description: Off White/ Lt Tan, Heterogeneous, Fibrous, Bulk Material Asbestos Types: Other Material: Cellulose 30 %, Fibrous glass 10 %, Non-fibrous 60 %			
06B-4 Location: Lay-In Ceiling II	108061853-07	No	NAD (by CVES) by C. David Mintz on 06/27/08
Analyst Description: Off White/ Lt Tan, Heterogeneous, Fibrous, Bulk Material Asbestos Types: Other Material: Cellulose 30 %, Fibrous glass 5 %, Non-fibrous 65 %			
06B-5 Location: Lay-In Ceiling II	108061853-08	No	NAD (by CVES) by C. David Mintz on 06/27/08
Analyst Description: Off White/ Lt Tan, Heterogeneous, Fibrous, Bulk Material Asbestos Types: Other Material: Cellulose 30 %, Fibrous glass 5 %, Non-fibrous 65 %			
06B-6 Location: Lay-In Ceiling II	108061853-09	No	NAD (by CVES) by C. David Mintz on 06/27/08
Analyst Description: Off White/ Lt Tan, Heterogeneous, Fibrous, Bulk Material Asbestos Types: Other Material: Cellulose 30 %, Fibrous glass 5 %, Non-fibrous 65 %			

Reporting Notes:

Analyzed by: C. David Mintz *C. David Mintz* Date *6/27/08*
 *NAD = no asbestos detected, Detection Limit <1%, Reporting Limits: CVES = 1%, 400 Pt Ct = 0.25%, 1000 Pt Ct = 0.1%; "Present" or NVA = "No Visible Asbestos" are observations made during a qualitative analysis; NA = not analyzed; NA/PS = not analyzed / positive stop; PLM Bulk Asbestos Analysis by EPA 600/M4-82-020 per 40 CFR 763 (NVLAP Lab Code 101904-0) and ELAP PLM Analysis Protocol 198.1 for New York friable samples (198.6 for NOB samples)(NYSDOH ELAP Lab # 10984); CA ELAP Lab # 2508; Note: PLM is not consistently reliable in detecting asbestos in floor coverings and similar NOB materials. NAD or Trace results by PLM are inconclusive, TEM is currently the only method that can be used to determine if this material can be considered or treated as non-asbestos-containing in New York State (also see EPA Advisory for floor tile, FR 59, 146, 38970, 8/1/94). NIST Accreditation requirements mandate that this report must not be reproduced except in full without the approval of the laboratory. This PLM report relates ONLY to the items tested.
 Reviewed By: _____

Baratta & Associates, Inc.
P.O. Box 293
Vinton, Virginia

LEA Roanoke County Schools
School 019 Green Valley Elementary School
Building Main

REASSESSMENT OF MATERIALS

Past or Initial Assessment: Hall-Kimbrell April 1989

HA-06A (LIC Type I) tested to be an ACM. LIC Type II is deemed a non-ACM.

The gypsumboard system (HA-01), the roof drain TSI (HA-050 and the breeching TSI (HA-09) tested to be non-ACMs.

Homogeneous Area	Description	Past Assessment Category #	Reassessment Category #
01	Gypsumboard system	Not evaluated	Non-ACM
02	Heating water fitting TSI	1	removed
03	Domestic HW fitting TSI	1	removed
04	Domestic CW fitting TSI	1	removed
05	Roof Drain fitting TSI	Not evaluated	Non-ACM
06A	LIC 2' x 2' Type I, long holes parallel to short side grey back with "install arrow"	Non-ACM	6
06B	LIC 2' x 2', Type II, long holes parallel to short side, tan back	Non-ACM	Non-ACM
07A	Floor tile 9"x9", white w/ tan streaks	5	5
07B	Black mastic for HA-07A	Not evaluated	5
08	Boiler TSI	1	removed
09	Breeching TSI	1	Non-ACM
10	Boiler room #1 Fitting TSI	1	removed
11	Tank TSI	1	removed
12	Boiler Room #2 Fitting TSI	1	removed

AHERA - Physical Assessment Categories - 763.88(a)(2)(b)

- 1 Damaged or significantly damaged TSI-ACBM
- 2 Damaged friable surfacing ACBM
- 3 Significantly damaged friable surfacing ACBM
- 4 Damaged or significantly damaged friable miscellaneous ACBM
- 5 ACBM with potential for damage
- 6 ACBM with potential for significant damage
- 7 Any remaining friable ACBM or friable suspect ACBM

Inspector:



Name: Michael Baratta Signature  Date 1/3/08

Accreditation Number: 3303 000065 Agency: Virginia DPOR

LOCATION OF ACBMs

Scale: see drawing

Reinspection Dates: May 6 & June 24, 2008

	Asbestos containing LIC panels HA-06A (see note)
	Asbestos containing floor tiles and mastics - HA 07A & 07B

LIC Note Asbestos containing LIC 2' x 2' Type I panels have parallel long holes and a grey back with "install arrow" printed on it. These are mixed with other non - ACM LICs. We believe the Type I LICs only exist in the area shown. This should be confirmed by the asbestos removal designer.

TSI-ACM may be hidden inside walls and ceiling spaces - Typical

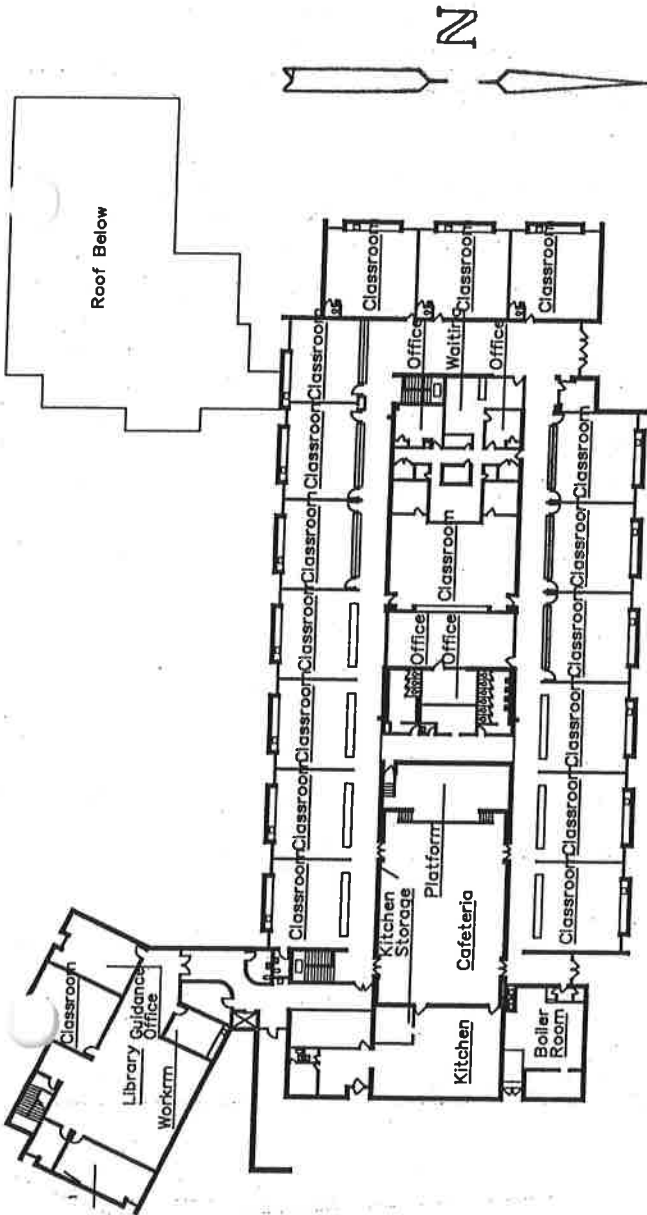

Upper Level Floor Plan

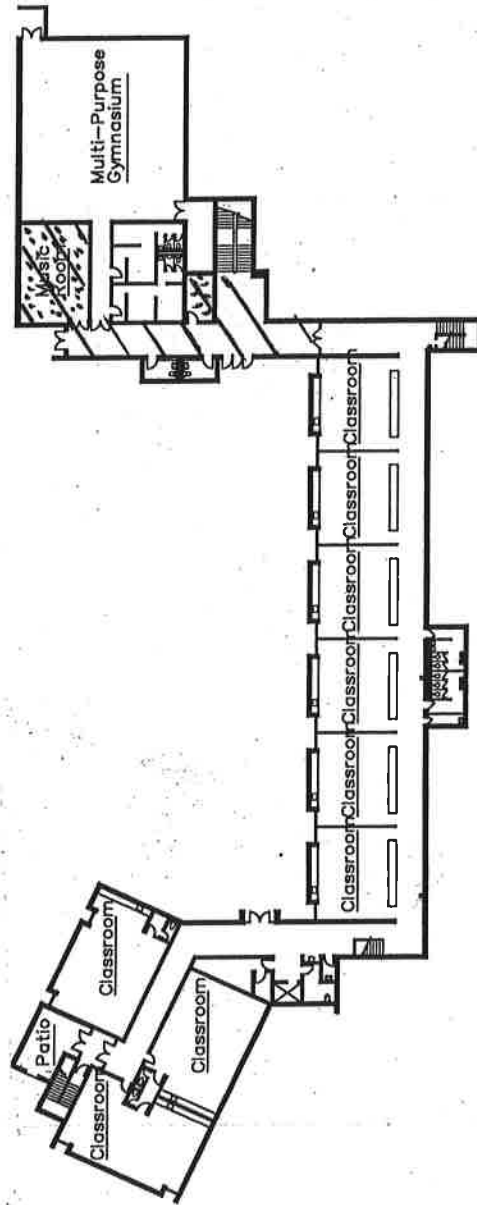

Lower Level Floor Plan

Virginia Department of Education
Energy and Facilities Service

LEA Roanoke County Schools
School 019 Green Valley Elementary School
Building: Main
Total cost to remove \$23,000

**RESPONSE ACTIONS
RECOMMENDED**

Each Location	Recommended Response Actions	Scheduled To Begin	Scheduled To Be Completed	Est. Cost To Remove
LIC 2' x 2' Type I, parallel long holes, grey back with "install arrow" (06A) *	Place in O & M Plan until removed	none	none	\$20,000
Floor tile and mastic (07A & 07)B	Place in O & M Plan until removed	none	none	\$3,000

* Numerous lay-in ceiling panels exist in this building. The asbestos containing LICs appear to exist only on the lower level and then only in the wing that houses the Music Room and Gymnasium. They are mixed with other salient LIC panels. Their extent should be confirmed prior to any abatement.

Management Planner:

Name: Michael Baratta Signature

Date 7/3/08

Accreditation Number: 3304 000208

Agency: Virginia DPOR

ASBESTOS MANAGEMENT, OPERATIONS AND MAINTENANCE PLAN

Green Valley Elementary School
July 3, 2008

This Asbestos Management Operations and Maintenance Plan is based on the Three Year AHERA Reinspection performed by Baratta & Associates, Inc on May 6 and June 24, 2008. It covers procedures to be followed in dealing with the Asbestos-Containing Materials (ACMs) found in the Green Valley Elementary School.

SUMMARY

One of the many types of lay-in ceiling (LIC) panels found in the building tested to be an ACM. This LIC appears to be confined to the Music – Gymnasium Wing.

The 9"x9" white tan streaked floor tiles (and associated black mastic) used in the Music Room and Gymnasium Office were also found to be Asbestos Containing Materials.

STAFF NOTIFICATION

The School should send all staff members a brief notice stating that Asbestos-Containing Materials exist in the Green Valley School Building.

ACM IDENTIFICATION

The following products were found to be Asbestos-Containing Materials (ACMs):

HA Number	Material
06A	LIC 2' x 2' Type I, parallel long hole, grey back with "install arrow"
07A	Floor tile 9"x9", white with tan streaks
07B	Black mastic for HA-07A

CARE OF THE ASBESTOS CONTAINING LAY-IN CEILING (LIC) PANELS IN THE GYM-MUSIC AREA

These are 2' x 2', panels used to finish the ceiling in the Music – Gymnasium Wing. They are mixed with other panels. The only way to identify them is to get above them and look at their backs. The asbestos containing LICs have a grey back whereas the others have tan. The asbestos containing LICs also have "install" and an arrow printed on their backs.

Do not hang any items from the ceiling. In addition, discourage the children from poking or throwing objects at the LICs.

The LICs are quite susceptible to damage caused by water leaking on them from above. Please report any water stains to the asbestos coordinator so the matter can be investigated.

Any damaged ceiling tiles should be replaced by qualified personnel.

CARE OF THE FLOOR TILES

The 9"x9" floor tiles and mastics in the music room and gymnasium office are ACMs. No drilling, sanding, or other abrasive or penetrating activities shall be used on the asbestos containing floor tiles. To do so may release asbestos fibers into the environment.

The flooring is tough and non-friable. It is doubtful anything other than forceful vandalism will deteriorate this material to a point where significant fiber release will occur.

Again, please report any damaged floor tiles to the asbestos coordinator so the matter can be investigated and the necessary corrective steps taken.

PERMIT REQUIREMENTS

Before any work that may require the disturbance of the noted Asbestos Containing Materials is performed, maintenance personnel or contractors shall obtain an Asbestos Work Area Permit from the School System's Asbestos Program Manager.